

# CONSTRUCTION & PLUMBING

The Official  
Magazine of the  
Master Plumbers  
& Gasfitters  
Association of WA

WA's largest infrastructure  
project begins to take shape



Volume 57 - Issue 2. June 2012



# WaterMarked Valves

THE COMPLETE RANGE



To see Zetco's comprehensive range of WaterMarked valves,  
contact us today for a free brochure or visit the website

**zetco.com.au**

1300 659 639

enquiries@zetco.com.au



# Hot water to the MAX

Now available in WA



## AquaMAX delivers more than just reliable hot water.

Built on a platform of leading technology and quality manufacturing, Aquamax gas and electric storage, continuous flow, heat pump and solar products give you more in hot water:

✓ **10 year cylinder warranty**  
on stainless steel gas  
storage models<sup>1</sup>

✓ **5 Star energy rating**  
on the entire gas  
storage range

✓ **15% better than MEPS**  
requirements on electric  
storage range<sup>2</sup>

*Giving you MORE in hot water.*

☎ 1800 676 000 More information: [www.aquamax.com.au](http://www.aquamax.com.au)

**AquaMAX**<sup>®</sup>  
Water Heaters

1. Full warranty conditions available on request from AquaMAX Australia Pty Ltd. See Aquamax's warranty set out in the Product Owner Manual or view at [www.aquamax.com.au](http://www.aquamax.com.au) 2. Excludes 50L (14%) and 400L single element (13%)

# JUNE 2012

## 2012 Executive Committee



**BILL BUSBY**  
PRESIDENT



**GEOFF KELLY**  
VICE PRESIDENT



**KIM BYRNE**  
IMMEDIATE PAST PRESIDENT



**DEREK ROWE**  
COMMITTEE MEMBER



**GEOFF COOK**  
COMMITTEE MEMBER



**SHANE CALEGARI**  
COMMITTEE MEMBER



**PAUL O'LEARY**  
COMMITTEE MEMBER



**LEE JOHNSON**  
COMMITTEE MEMBER



**BOB GOODCHILD**  
COMMITTEE MEMBER



**RON GRANT**  
COMMITTEE MEMBER



**PAUL MANIFIS**  
COMMITTEE MEMBER



**MATT JOHNSON**  
COMMITTEE MEMBER



**PETER THOMPSON**  
COMMITTEE MEMBER

## Foreword

- 3 President's Note & CEO Report

## Features

- 5 Building Commission  
7 Water Corporation  
8 Energy Safety  
9 Master Builders  
10 Your Business  
13 Movers and Shakers

## Events

- 14 Autumn Golf Day  
15 MPGA Out and About

## Regular Features

- 16 World Plumbing  
18 Cover Story - Fiona Stanley Hospital  
20 Technical Update  
25 Product News  
29 Occupational Health and Safety  
30 Personal Health  
31 Training  
32 Association News

## COVER STORY

Plumbers Unite!  
WA's largest  
infrastructure project  
begins to take shape  
Page 18



### Master Plumbers & Gasfitters Association

#### Postal address:

PO Box 5216, East Victoria Park, WA 6981

#### Street address:

Level 3, 353 Shepperton Road, East Victoria Park, WA 6101

Ph: (08) 9471 6661 Fax: (08) 9471 6663

Website: [www.masterplumbers.asn.au](http://www.masterplumbers.asn.au)

#### Publisher:

Master Plumbers & Gasfitters Association of WA

#### Editor:

Sarah Forrest

Ph: (08) 9471 6621 (direct), Fax: (08) 9471 6663

email: [sarahf@mpawa.asn.au](mailto:sarahf@mpawa.asn.au)

#### Design & Printing by:

Maaxx Marketing

Ph: (08) 9467 0161

### MPGA Office bearers:

President: Bill Busby

Vice President: Geoff Kelly

Immediate Past President: Kim Byrne

CEO: Murray Thomas

### Executive Committee:

Derek Rowe, Geoff Cook, Shane Calegari, Paul O'Leary, Lee Johnson, Bob Goodchild, Ron Grant, Paul Manifis, Peter Thompson and Matt Johnson.

Master Plumbers & Gasfitters' Trade Magazine is produced by the Master Plumbers & Gasfitters Association of WA.

Statements and information appearing in the publication must not be interpreted as having the endorsement or being the opinion of the Association, which takes no responsibility for the correctness of statements or comment made in the publication.

# Advance forward with advertising

Over the past 2 years the MPGA profile within the community and the construction industry has stepped up a level.

The move into a high profile location in East Victoria Park has enabled us to build our branding and marketing strategy. Signage on the new home of the MPGA will be in place over the coming months increasing the Association's exposure to thousands of cars every day. In addition to this over 15 MPGA vehicles are now featuring our motto "Supporting Successful Plumbers". A lot is made of the need to present a professional image within the workplace, extending to both ourselves as plumbers and gasfitters and also the staff within the Association.

The 2012 membership packs include information regarding the discount

available to members who advertise with the Community Newspapers using the MPGA logo. The logo is a symbol of integrity, professionalism and unity and the MPGA encourages members to advertise as Master Plumbers as well as supporting fellow members by featuring the logo in their ads.

The MPGA's promotion of Master Plumbers continues to feature in metropolitan newspapers and is now featuring in regional newspapers to support our country members.

Our message is simple "Is your Plumber a Master Plumber?"

In planning your own advertising and promotional activity I encourage you to utilise your membership of such a strong industry body that protects the structure of the plumbing industry and promotes the health and well-being of the community.

Regards,  
Bill Busby

President, Master  
Plumber & Gasfitters  
Association WA



**BILL BUSBY**  
PRESIDENT

"Our message is simple "Is your Plumber a Master Plumber?"

# Contractors Beware!

I think all members are aware or should be aware of employer responsibilities and obligations as defined by the ATO.

It is coming to that time of the year to lodge your returns and members should understand the new legislation that specifies that all payments to contractors will be reported to the ATO. This new reporting requirement will commence on 1 July 2012. The MPGA will be conducting workshops on this matter for members in July. In the meantime, I would suggest that there are some things that you as business owners can do.

Firstly, check that you and the people that contract to you have a clear understanding of your relationship. The ATO defines employer/employee relationships by a number of areas, not only to the extent that you have a signed a contract to support that relationship.

Secondly, reinforce this in your own mind and ensure the person contracted to you clearly understands the following criteria:

- The contractor doesn't work exclusively for you.
- You are not in control of the contractor's actions.
- You pay the contractor to produce a result, not by the hour.
- The contractor provides his own plant, tools and equipment
- The contractor has his own business name and/or logo on his uniform (not yours).
- You do not pay the contractor annual leave, sick leave, long service leave and superannuation.

- The contractor works to his policies not yours.
- The contractor has his own liability under your contract.

Plus more!

Should you need more information on this matter, don't hesitate to call us now on 9471 6661 or refer to the ATO's website for clarity.

The advice that has been passed onto us from the ATO is that it is not worth trying to avoid the requirements as they are set to focus on building and construction nationally in 2012 - 2013.

Regards,

Murray Thomas

CEO, Master Plumber & Gasfitters  
Association WA



**MURRAY THOMAS**  
CEO

## Vale Garry Dunbar

Plumbers' Licensing Board Regional Plumbing Compliance Officer for the Kimberley Region.

The MPGA Executive Committee, on behalf of all members and staff extend our deepest sympathy to Garry's family, friends and colleagues. Garry will be remembered for his significant contribution to the plumbing industry in his capacity with the PLB from 2003. Before that, Garry worked on the tools and as a plumbing supervisor.

His caring nature and his passion to make a difference drew him to the North West, the place he loved most.

Rest in peace mate.

# Freezing hot.

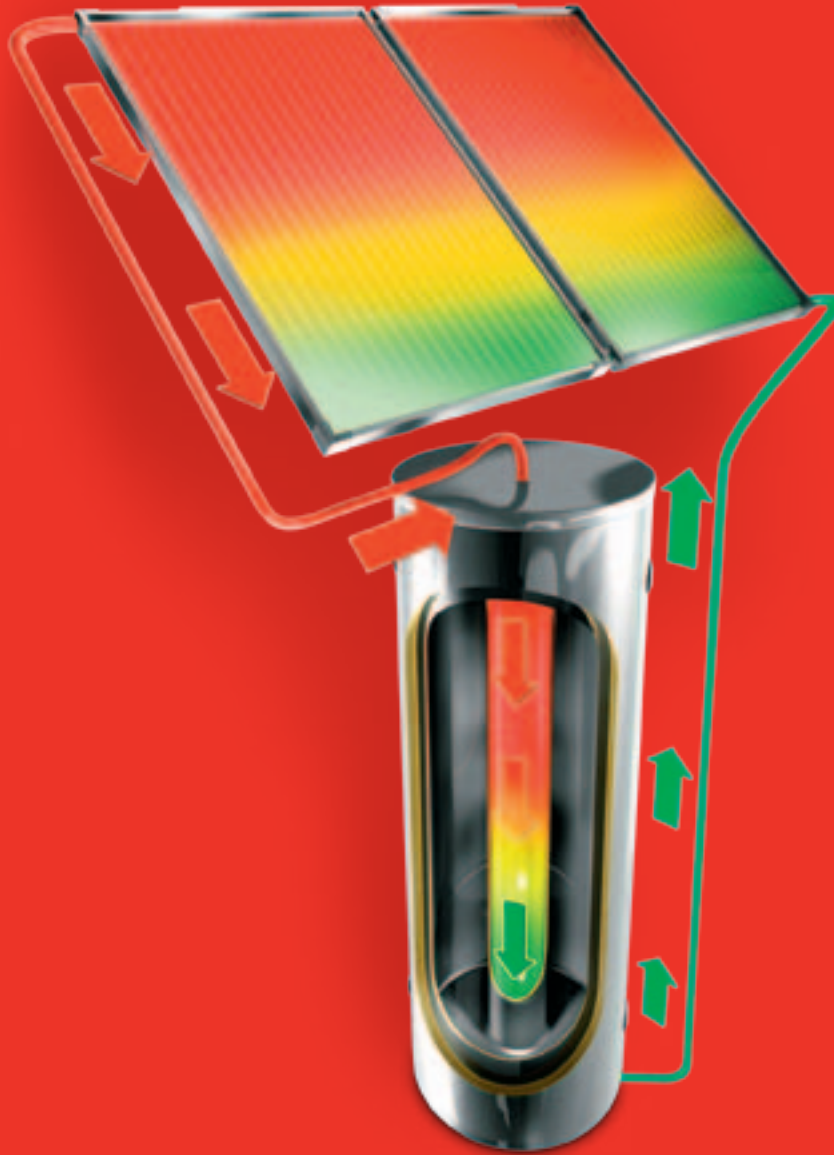

Rheem's unique Drain Back technology offers protection against freezing and overheating in all weather conditions.

#### Rheem Premier® Solar hot water

- Genuine frost protection
- Indirect glycol heating
- Gas or electric boosted
- Solar collectors and storage tanks are made in Australia

COMES ON STEADY, HOT AND STRONG.

INSTALL A



AUSTRALIA'S NO. 1

# Unlicensed drainage plumbing work

The Plumbers Licensing Board is concerned about unlicensed plumbing work occurring in the drainage plumbing sector in Western Australia.



**RON SANDELL**  
DIRECTOR OF COMPLIANCE  
& COMPLAINTS

While there are circumstances where unlicensed labourers can assist, such as carrying pipes to the point they are to be laid, this does not include the undertaking of any plumbing work. Where plumbing work is undertaken by an unlicensed person they are in breach of the Water Services Licensing (Plumbers Licensing and Plumbing Standards) Regulations 2000 and could be prosecuted for performing unlicensed plumbing work.

The regulations establish drainage plumbing work as work other than exempt work, that involves the installation, alteration, extension, disconnection, repair or maintenance of underground pipes and other fittings used or intended to be used for the carrying of -

- i) wastewater to a sewer; or
- ii) wastewater or other waste to an apparatus for the treatment of sewage.

Licensed plumbing contractors who employ unlicensed persons

to carry out plumbing work also risk prosecution by the Plumber's Licensing Board and a maximum penalty of \$5,000 as well as disciplinary proceedings which could result in sanctions including licence suspension or cancellation.

The qualifications required to obtain a tradesperson's licence (drainage plumbing) in Western Australia include:

- i) a Certificate II in Drainage issued by a registered training provider or an equivalent Western Australian qualification as determined by the Plumbers Licensing Board; or
- ii) a recognised qualification in drainage plumbing work and the provision of evidence to the satisfaction of the Plumbers Licensing Board of at least 2 years' practical experience in drainage plumbing work; or
- iii) having passed a test in drainage plumbing work, involving both theoretical and practical components conducted by an

approved person or body and the provision of evidence to the satisfaction of the Plumber's Licensing Board of at least 2 years practical experience in drainage plumbing work

**Building  
Commission**



Government of Western Australia  
Department of Commerce  
Plumbers Licensing Board

"Where plumbing work is undertaken by an unlicensed person, they are in breach of the Water Services Licensing Regulations"

## Building Dispute? Problems with a contract?



- ✓ Over 30 years experience
- ✓ Fast, accurate and timely advice
- ✓ Building, Construction and Engineering Disputes
- ✓ Tender advice



**FOR MORE INFORMATION CONTACT GREG DUNNE**

Level 1, 9 Stirling Street Bunbury WA 6230

greg.dunne@sleeanderson.com.au

Telephone 08 9792 0920 Fax: 08 9721 1271



Training & Apprentice Employment  
DIVISION OF MPA GROUP

# Have you thought of doing your PCL & Gas?

## Approximately 70% funded by the Construction Training Fund

### COURSES

- **Plumbing Contractors' Licence - 52291**
  - Business
  - Drainage
  - Water supply
  - Sanitary
- **Service Type 'A' Gas Appliances - CPCPGS4012A**
- **Certificate III in Gasfitting** (Non Apprenticeship Pathway)
  - (Meets Energy Safety requirements)

### AVAILABLE

Full time and part time courses

### WHERE

MPA Skills, 106 Caledonian Avenue, Maylands



Contact MPA Skills on (08) 9471 6600  
or visit [www.mpaskills.com.au](http://www.mpaskills.com.au)



Training & Apprentice Employment  
DIVISION OF MPA GROUP



DIVISION OF MPA GROUP





# Do you know the benefits of being a Waterwise Specialist?

The Waterwise Specialist Program aims to build the profile of endorsed waterwise services available to help customers save water inside and outside the home.



Over the past 6 months, the Corporation's Waterwise Specialists web page has had over 2350 page views for the period and our call centre has received an average of 300 calls per month regarding Waterwise Specialist information.

The people of WA want to know how to reduce their water use and soon customers will expect plumbers to offer waterwise services. Being a Waterwise Specialist will give you an edge over competitors in your area and the expertise to provide specialist advice on waterwise products and services.

Are you a Waterwise Specialist? If not, sign up today!

Benefits of being a Waterwise Specialist are:

- Waterwise training for yourself and/or your staff on the latest waterwise principles, practices and products.

- Access to Waterwise branding to promote yourself as a Waterwise Specialist and differentiate yourself from the competition.
- Promotion by the Water Corporation in Waterwise Specialist advertising campaigns appearing on billboards, bus shelters, radio, television, print and online.
- Access to a range of Waterwise promotional materials including stickers, vests, hats, brochures etc for your business.
- Waterwise Specialists will be given first preference, wherever possible, for services the Corporation requires.
- The Corporation will recommend Waterwise Specialists to customers who enquire generally and in the roll out of community projects and initiatives.

To find out how you can become a Waterwise Plumber Specialist, please contact MPA Skills on (08) 9471 6600.

For more information on the Waterwise Specialist Program visit [www.watercorporation.com.au](http://www.watercorporation.com.au).



"Being a Waterwise Specialist will give you an edge over competitors in your area"

## FOR ALL YOUR GREASE TRAP AND WASTE WATER REQUIREMENTS, LOOK NO FURTHER THAN GREASE TRAP SOLUTIONS



**GREASE TRAP SOLUTIONS**

[www.greasetrap.net.au](http://www.greasetrap.net.au)

### Our Services Include:

- Waste Water Audits
- Grease Trap Pump-Outs
- Grease Trap Installations
- Grease Trap Repairs & Maintenance

All work is carried out in accordance with Water Authority Guidelines.

We do more than just pump out grease traps - ours is a complete service. We scrape the sides and check both inward and outlet pipes to ensure that the unit operates effectively.

### HANDY HINT

Always check sampling points first for blocked drains.

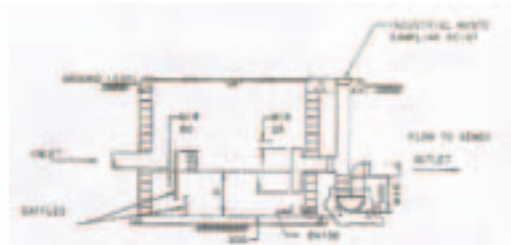

**Plumbers - give us a call for all your grease trap pump out requirements. We are the most cost effective and the best.**

Call us for an obligation free quote on your grease trap requirements!

**CONTACT US:** Website: [www.greasetrap.net.au](http://www.greasetrap.net.au) | Office Phone/Fax: 9470 9290  
Gerry Richardson | Mobile: 0427 770 549 | Email: [gerry@greasetrap.net.au](mailto:gerry@greasetrap.net.au)



**KEVIN HOOPER**  
ENERGYSAFETY  
CHIEF GAS INSPECTOR

# Commercial Gas Installations By Kevin Hooper

A prominent plumber/gasfitter working close by this near completed installation noticed a gas appliance flue that had been terminated in what appeared to be in a non-compliant position.

His concern was logged at EnergySafety and from that, the network operator (ATCO Gas Australia) sent one of their gas inspectors to investigate.

A water heater was located in what appeared to be an undercover car park at the rear of the restaurant. The restaurant was at street level with two apartments on the floors above. In this case, having a large high recovery storage water heater presented a number of problems:

1. A gas appliance installed in a garage/carpark is to be raised 450mm above the floor, ref AS/NZS 5601:2010 clause 6.3.10(i) Installation in a garage – burners

or pilot burners and combustion air intake to be at least 450mm above the floor level.

There have been instances in the past where a spillage of fuel (petrol) has occurred in the garage and the vapours from this spillage have been ignited by the pilot in a nearby storage water heater.

2. As an alternative for this installation, consideration should be given to install a continuous flow gas water heater.

3. If the water heater was to remain, AS/NZS 5601:2010 Clause 6.3.2 Protection from physical damage (from motor vehicles) may also be a consideration.

Prior to submitting your price to the builder when estimating off a plan, consider all areas of the commercial gas installation to ensure the installation of the gas appliances remain compliant.

It is quite evident in this instance that the installing plumber/gasfitter was not conversant with this type of gas installation. The Australian

Standards AS/NZS 5601:2010 Part 1 General Installations is a good starting point for those wanting to brush up on their installation knowledge. A3276398



Flue terminal circled in red above



**IMPORTANT INFORMATION**  
for building/construction  
industry employers...

ARE YOU  
AWARE OF THE  
**'Mates In  
Construction'**  
program?



'Mates In Construction' is a program adopted from Queensland by the WA Construction Industry Redundancy Fund to provide a free counselling service to all workers in building and construction work activities.

This program is aimed at developing an awareness of the high incidence of suicide as a result of personal stress and provides specialist support for employees who may be having personal problems.

'Mates In Construction' is a problem solving concept, aimed at helping workers – helping to keep them on the job - keeping them in the building/ construction industry and helping them to perform at their best without personal distractions.

Tell your workers about the program – the longer we can help them to stay in the industry the better!

### ARE YOU AWARE OF THE NEW INDEMNITY FOR MEMBERS SCHEME AVAILABLE?

The WACIRF has established in conjunction with Jardines Insurance a unique indemnity scheme that provides compensation coverage:

- Leisure travel cover;
- Income protection in the event of an accident on journey to or from work;
- Funeral benefits for members, spouses and dependents;
- and more...



The West Australian Construction Industry Redundancy Fund – working for the interests of everyone in the Construction and Building Industry...

**For details phone 9481 0259**

or email [info@wacirf.com.au](mailto:info@wacirf.com.au)



# Residential Construction in WA

Master Builders' Director of Communications, Geoff Cooper reviews the outlook for residential construction in WA.

The outlook for residential construction in WA remains clouded but there are some positive trends emerging.

We have had several years of weakness. Dwelling approvals have dropped from over 24,500 in 2009-10 to about 19,500 in the last 12 months, falling about 10% each year. Confidence in our residential property market is not high and we have a lot of home owners and investors selling or unwilling to move due to the stalled secondary market.

Despite the downturn, there are several indicators that suggest we will have a stronger residential construction market ahead in WA.

Our Minister for Planning, Mr John Day, released a revised population projection of more than 3,000,000 people by 2026. This is an increase of about 400,000 people state-wide than previous projections made in 2006. The positive outlook for our population was affirmed by ABS reports which have regularly confirmed our new status as the fastest growing state in Australia.

If current population trends continue, this means we will need to house around 45,000 people a year – although this will vary annually along with fluctuations in economic growth, migration etc. This suggests we need to produce more than the 20,000 homes a year to house the 900 plus arrivals to our state each week.

Indeed, Housing Industry Forecasting Council Chair, Stuart Darby, told a Master Builders Economics Breakfast that we may need around 27,000 new homes a year. This would require our industry to expand in the longer term to deliver housing for our new community members.

Combine this population growth with slower dwelling construction figures over the last 3 years for

residential housing stock every year and we can anticipate pent up demand which can help create the next upturn in the construction cycle.

The current demand for residential rental properties will also assist to increase demand for homes. Rents have increased at well above the inflation rate and some prospective tenants are having to queue for home inspections. Yields in many WA suburbs have reached 5%. This environment gives investors more confidence in their ability to secure a rental income stream from their investment. The tight rental market will also encourage some undecided renters to take the step of building their own home. This will help push us up off the bottom of the construction cycle.

Potential home buyers will also be considering the current availability of trades and shorter construction times experienced in the industry. Master Builders' Building Industry Employment Monitor shows that job advertisements for trades in the West Australian are tracking at around a third of the levels of two years ago. This will help keep investors' holding costs down and reduces investment risk.

We also have ample land supply in the short and medium term. There are almost 50,000 conditionally approved lots for developers to construct within the next 4 years in Perth and Peel. Developers are offering attractive incentives for land purchases in most areas of WA. Interest rates have also shifted to a downward trend, again creating a better environment for home buyers and investors.

However, not all the indicators are positive. Recent political changes in Europe are once again bringing international financial uncertainties before the public's eye with gyrating financial markets. Finance is tight for many. We also have a lot of traditional investors deleveraging and not investing. No doubt that will add to the cautious approach of investors and developers who are yet to return in numbers into the construction market.

While you can never be certain, it seems overall that there is a good argument that the market is bottoming and that a more active construction market is likely in the medium term in WA.

“Despite the downturn, there are several indicators that suggest we will have a stronger residential construction market ahead in WA.”



# You've earned it today. You get it today. Everyday Settlement from the Commonwealth Bank.

For many MPGA members, weekends and public holidays are amongst the busiest trading days of the week. So it can be frustrating if you have to wait until Tuesday before your weekend takings from merchant sales are ready and waiting in your bank account.

With Everyday Settlement from the Commonwealth Bank you'll get access to each day's takings by the end of the day, every day\* of the year, including weekends and public holidays.

To take advantage of Everyday Settlement, all you need is a Commonwealth Bank merchant service linked to a Commonwealth Bank business transaction account. And don't forget, MPGA members can also enjoy special rates and discounts on Commonwealth Bank merchant services, every day of the year.

## How Everyday Settlement helps you

Everyday Settlement, every single day	Forget about waiting for days to draw on your takings from weekends and public holidays. When you settle to a Commonwealth Bank business account, you'll have access to your money at the end of each day, 365 days a year.
Faster cash flow	With same day access to funds, you can say goodbye to those weekend and public holiday cash flow gaps. And because you can draw on your takings on the day, you'll have more freedom to negotiate better terms with suppliers.
More visibility	When combined with CommBiz or NetBank, the Bank's award-winning^ online banking platforms, you'll benefit from up-to-date visibility of your financial position, so it's easier to keep track and stay on top of your cash flow.
Late trading	If you're trading late, you'll see all your transactions up to 10pm, so you'll have access to a full day's trading.
Easier reconciliation	Because your transactions for the weekend or public holidays won't be combined with the next business day's settlement, you'll benefit from easier daily reconciliation.
Reduced interest costs	If you rely on overdrafts or other borrowings to cover cash flow gaps, Everyday Settlement helps you use them less, saving interest and freeing up cash.

## Find out more

Start better business banking today, call the MPGA Membership Services team on 9471 6661.

Important information: \*Available on transactions made before 10pm AEST for customers with a Commonwealth Bank business transaction account and a linked Commonwealth Bank merchant facility. Third party products not included. ^CANSTAR Best Online Banking award 2010. Interactive Media Outstanding Achievement Awards 2010 (NetBank and CommBiz). The MPGA may receive a fee from the Commonwealth Bank of Australia for each successful referral. This has been prepared without considering your objectives, financial situation or needs, so you should consider its appropriateness to your circumstances before you act on it. Terms and conditions are available from [commbank.com.au](http://commbank.com.au) Commonwealth Bank of Australia ABN 48 123 123 124.

Partnering with



# Your business earned it today. So you get it today.

With Everyday Settlement for your business, the credit and EFTPOS sales you make will settle on the same day, every day\*.



**SAME DAY  
EVERYDAY  
SETTLEMENT  
365 DAYS**

**Start better business banking today.  
Call the MPGA on 9471 6600.**



Partnering with



Important information: \*Available on transactions made before 10pm AEST for customers with a Commonwealth Bank business transaction account and a linked Commonwealth Bank merchant facility. Third party products not included. This has been prepared without considering your objectives, financial situation or needs, so you should consider its appropriateness to your circumstances before you act on it. The MPGA may receive a fee from the Commonwealth Bank of Australia for each successful referral. Terms and conditions are available from [commbank.com.au](http://commbank.com.au) Commonwealth Bank of Australia ABN 48 123 123 124. CLA1544

# Preparing Progress Claims



PAUL FUNNELL

Progress claims are tax invoices submitted to the customer or builder and represent a claim for payment on an agreed regular basis for work completed. It is important to set out the claim in accordance with the requirements of the state or region where the claim is to be processed (see your trade association for details).

Based on the assumption that the project has an agreed tender price, the progress claims will be proportional to the completed work at a given time. A progress claim is not associated with the expenditure that has occurred, such as the cost of materials and the labour costs for installing those materials; rather it is an assessment of the completed work at an agreed date. The completed work is expressed as a percentage.

When estimating a project, consideration should be given to the layout for future progress claims. Houses may be in four stages such as; under slab, hot and cold water installations, external drainage and finishing off. While commercial projects are based on the percentage of work completed for each individual section such as; sanitary plumbing, cold water, hot water, gas services, fire services, house drainage and stormwater drainage.

A typical progress claim may be presented as follows:

Item	Contract	Claim	Amount
Sanitary Fixtures	\$22,500	20%	\$ 4,500
Sanitary Plumbing	\$11,200	60%	\$ 6,720
Cold Water Services	\$ 9,650	100%	\$ 9,650
Hot Water Services	\$ 8,000	50%	\$ 4,000
Drainage	\$12,400	25%	\$ 3,100
<b>Total</b>	<b>\$63,750</b>	<b>43.88%</b>	<b>\$ 27,970</b>

The formula for calculating the overall percentage claimed to date is:

$$\frac{\text{Amount Claimed} = \$27,970}{\text{Total contract value} = \$63,750} \times 100$$

**Total 43.88%**

A progress claim certificate should be lodged with the customer or builder which provides an opportunity for an agreement to be reached. The certificate which also includes the value of retention to be withheld becomes the basis for a tax invoice.

There is a link between progress claims and gross profit, although they are viewed separately. The gross profit for a project or for a section of the project is the claim to date minus the sum of the expenses. That is the sum of material costs, labour costs and other expenses, subtracted from the progress claim for the particular section of work.

For example:

Sanitary plumbing in the above example is, \$11,200 and the claim is for 60% (\$6,720). If the expenses to date are \$6,900 a loss of \$180 is recorded, however if the expenses are \$5,500 a profit of \$1,220 is recorded. It is therefore important to submit accurate claims to ensure the project reports are also accurate.

Progress claims provide cash flow for the company so ensure they are submitted on time, are accurate and backed up with the correct documentation.

## Paul Funnell's "Estimating Seminar"

Learn now to achieve accurate processes and improve profits!

Come along on Wednesday 11th July 2012 & Thursday 12th July 2012 to take part in a seminar hosted by Paul Funnell himself.

Held at MPA Skills, Maylands this is a seminar not to be missed!

Contact MPA Skills on: 9471 6600 to register and find out more information

**"Know when to say no! Because the price is too low"**

# 1 pipe... 2 fitting systems

Available at Galvin's  
(08) 9441 8544

the ease of  
**crimpPlus®**

The Crimp Plus® system provides quicker installation for specialty applications. Use the new Crimp Plus® fittings and get the benefits of Pex pipe, combined with the ease of a Crimp fitting.

the security of  
**pexPlus®**

Pex Plus® provides a viable alternative to other pipe systems for hot & cold water, compressed air, rainwater, re-cycled water, hydronic heating and much more.

# MPA Skills

## Training WA's best Plumbing Apprentices

MPA Skills is the largest provider of specialist apprentice training for the Western Australian Plumbing Industry

### MPA Skills Training

- State of the art training facility at Bayswater and Maylands
- Workplace assessment, skill level assessment and Skills Tracker
- Report Card for each apprentice and employer at each training stage
- Industry based and Industry focused

**South of River  
Jandakot Campus  
Now Open!**



Training & Apprentice Employment  
DIVISION OF MPA GROUP



DIVISION OF MPA GROUP

Contact MPA Skills on  
**(08) 9471 6600**  
or visit  
**[www.mpaskills.com.au](http://www.mpaskills.com.au)**

**ENSURE YOUR APPRENTICE RECEIVES THE HIGHEST QUALITY TRAINING**

# Movers & Shakers



9244 8144

www.pipelinehydraulics.com.au

Pipeline Hydraulics has had some internal changes recently. The team's long standing Commercial Project Manager of 20 years, Mark Lowe has recently taken on the role of General Manager. This change has seen Barry Scriven, another valued member of the team move into the position of Commercial Project Manager. Pipeline Hydraulics welcomes both Mark and Barry into their new roles and looks forward to their ongoing professional development within the company.



Bosch would like to congratulate and welcome Sam Tsakisiris who has been appointed the new State Sales Manager for Bosch. Sam started with Bosch only a month ago and is enjoying his new role which he has settled into well.



### Shane Ross moves to Heat Trap Solar Pty Ltd

Heat Trap Solar is an innovative and environmentally Australian owned and operated company manufacturing hybrid solar hot water heating here in WA. Shane saw an opportunity to be a part of a company dedicated to making a difference in the plumbing industry, concerned about the environment and provided a product where you could invest in your energy future. Shane can be contacted on 0449 815 456 or visit their website to view the product at [www.heat-trap.com.au](http://www.heat-trap.com.au).

# Step through the TradeDoor™ and make life simpler!



- ✓ Streamline your pricing and invoicing process
- ✓ Keep track of your orders
- ✓ View and search for your frequently purchased items

Unlock TradeDoor™ today by visiting [www.tradelink.com.au](http://www.tradelink.com.au)



www.twitter.com/thetradedoor  
www.youtube.com/user/thetradedoor  
www.facebook.com (search: TradeDoor)

© 2012 Tradelink Plumbing Centres. All rights reserved. Specifications and materials may change without notice. Products are the subject of registered trademarks, designs and patents.



**ASHLEE PHUR**  
EVENTS MANAGER

# Autumn Golf Day

The Master Plumbers & Gasfitters Association of WA and ATCO Gas Australia Autumn Golf Day was held on Friday 20 April in the beautiful surroundings of the prestigious Vines Resort and Country Club.

What started with a week of rain and thunderstorms turned out to be a perfect day for golf with the sun shining bright. The course was in immaculate condition and once again, the event was a sell out with 132 competitors taking to the course.

Teams enjoyed 18 holes of golf in Ambrose format, taking part

in various novelty hole activities around the course including the famous Galvin's German Sausage tent, the Solahart wine and cheese tasting, BBQ's by MPA Skills and Tradelink and finishing up with a massage on the 18th hole. After an entertaining day of golf, players enjoyed a few drinks and a BBQ dinner where prizes were given to the day's winners.

Everyone who takes part in an MPGA golf day will tell you that it's not just about relaxation, fresh air, exercise or the great prizes, it's about networking and catching up with industry friends and colleagues. Our golf days are tremendously successful and we look forward to the next one being held at Burswood on Friday 14 September.

The MPGA would like to thank all those who took part in the day and we give special acknowledgement to our major partner, ATCO Gas Australia and event sponsors, whom without their support this day would not be possible:

- MPA Skills
- Galvins
- Tradelink
- Iplex Pipelines
- EBM Insurance
- REHAU
- Solahart
- Tyco Flow Control
- Dial before you Dig
- Geberit
- Grease Trap Solutions
- Command IT
- Philmac
- Bosch
- Solar Edwards
- Aquamax



Team Philmac take a break from golfing



Bennet Saicich, Craig Myles, Nathan Barnett and Chad Mainstone

## THE WINNERS:

**1st Place – Command IT Services**  
Lee Hancock, Jeremy Lunt, Brian Buzzard, Chris Coyne

**2nd Place – Tradelink**  
Daren Robinson, Andrew Hagan, Wayne Hammer, Rob Diamond

**3rd Place – Galvins #2**  
Bennett Saicich, Steve Monks, Armando Rodi, Dave Fontez

**NAGA – Iplex Pipelines Australia / Diamond Plumbing & Gas**  
Wayne Anderson, Paul Coci, Vincent Freeman, Robert Mitchell

**Longest Drive**  
Grant Raynor, Rayco

**Nearest to the Pin**  
Mel Oddo, Sunrise Plumbing

**REHAU Closest to Pipe**  
Matt Cocking, Galvins Spearwood

## MARK YOUR DIARY

JUL

**Tuesday 3 July**

Mandurah Trade Show & Industry Forum

**Friday 27 July**

Awards for Excellence close of entries

AUG

**Thursday 2 August**

Perth Trade Show

**Thursday 9 August**

OGM & Information Seminar

**Friday 24 August**

Apprentice of the Year Competition Day

**Friday 24 August**

Awards for Excellence submissions due

SEP

**Friday 14 September**

Spring Golf Day- Burswood





Members and exhibitors come together at the Broome Trade Show



Bunbury trade show

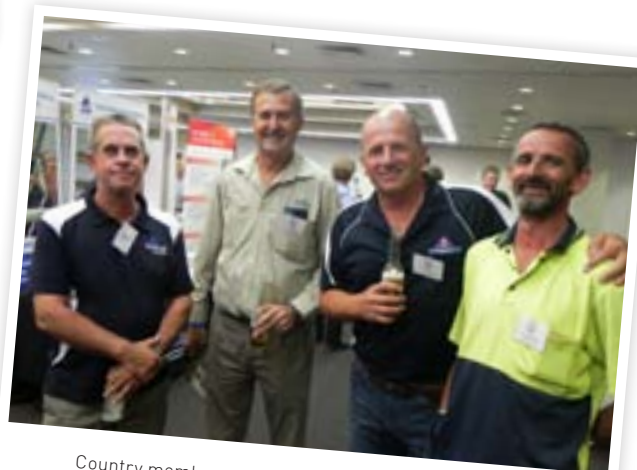

Country members catch up at the Bunbury trade show



Geraldton trade show



Brad Cheeseman and Raymond Black at the Geraldton Trade Show



Broome Trade Show



Karratha Trade Show



STUART HENRY  
WORLD PLUMBING COUNCIL  
SECRETARIAT

## WPC Education & Training Scholarship 2012

The World Plumbing Council Chairman, GP Russ Chaney has announced that scholarship applications are now open for individuals involved in plumbing industry training wishing to visit another country for the purpose of researching and furthering plumbing training and skills development.

The recipients of the scholarship in 2010 and 2011 are great examples of the diversity that is available through the WPC Education and Training Scholarship Program.

In 2010, Robert Goodchild of Perth, Western Australia travelled to South Africa and as part of his study tour visited a township of some 33,000 people with poor water supply, few toilets and no sewerage with little or no infrastructure to support sustainable living for the community. His report illustrated the value of well qualified and trained plumbers supported by an effective regulatory system.

The 2011 scholarship recipient, Chintan Daiya of Mumbai, India chose to visit Singapore which boasts a highly developed water reclamation system (NEWater) and desalination system to ensure adequate water supply for the well developed and populous island state. Mr Daiya went on to say that the WPC Education & Training Scholarship provides an excellent opportunity for an individual to witness and learn about issues of public health and environmental sustainability in another country, whilst considering the training mechanisms and structures to support these observations.

WPC Executive Board Director and Chairman of the WPC Education & Training Standing Committee, Rich Prospal commented that "the WPC Education & Training Scholarship opens a multitude of opportunities for the recipient. If only to broaden your horizons on how things are done in other parts of the world or

to immerse yourself into a different culture or to make new friends is a great learning/teaching experience. The whole idea is to expand the thought that plumbing is important in everyone's health and everyday life."

The value of the WPC Education and Training Scholarship is up to US\$10,000 which covers the costs associated with return travel, lodging, meals and incidentals. The World Plumbing Council initiated the Education and Training Scholarship in 2003 and it continues to this day to be one of the most beneficial programs offered by the WPC to the plumbing industry at large.

Please visit [www.worldplumbing.org](http://www.worldplumbing.org) and click on Communications then Education & Training Scholarship to see the reports of previous recipients and to download an application for the 2012 Scholarship. Applications close on the 31st July 2012.

"The WPC Scholarship provides an excellent opportunity learn about issues of public health and environmental sustainability"

## World Plumbing Day International Poster Competition

A total of 81 finalists from hundreds of posters submitted by school children from many countries around the globe were entered in the 2012 World Plumbing Day

Poster Contest. Children in grades 2 through 5 from Jamaica, Trinidad, Scotland, British Columbia & Ontario, Canada, Newfoundland and the USA - Wisconsin, Ohio, California & Wyoming submitted the posters.

The posters were judged primarily for the message that World Plumbing Day represents - that plumbing is vital to good health; the role that plumbing plays in our everyday life and the role that plumbing plays in environmental issues. The artistic merit of the posters was secondary. Of the 81 posters the judging panel from the American Society of Sanitary Engineering (ASSE), on behalf of WPC chose the 10 best posters, which were then put on display at the ASSE Mid-Year Board meetings for judging by the members present at the meeting.

The first place winner was: Alexis Briano, Grade 5, La Verne Heights Elementary School, California

Alexis Briano's poster was selected as the grand-prize winner in a

global competition administered by the World Plumbing Council (WPC) as part of the celebration of the third annual World Plumbing Day. Children under the age of 10 (first through fifth grades) were invited to participate in the global competition by designing a poster illustrating the important role plumbing plays in our society. The WPC's judging committee reviewed hundreds of posters from around the world and chose Alexis Briano's poster as the most worthy of the top prize - US\$1,000 for her school and US\$100 for herself.

When asked what she was going to do with her prize money, Alexis smiled and replied "I'm not sure yet."

During his presentation to the school, which included their mascot, Dan D. Lion, Chaney reminded the students that there are children their age in other countries who are not fortunate enough to have plumbing systems and that they should use water wisely.

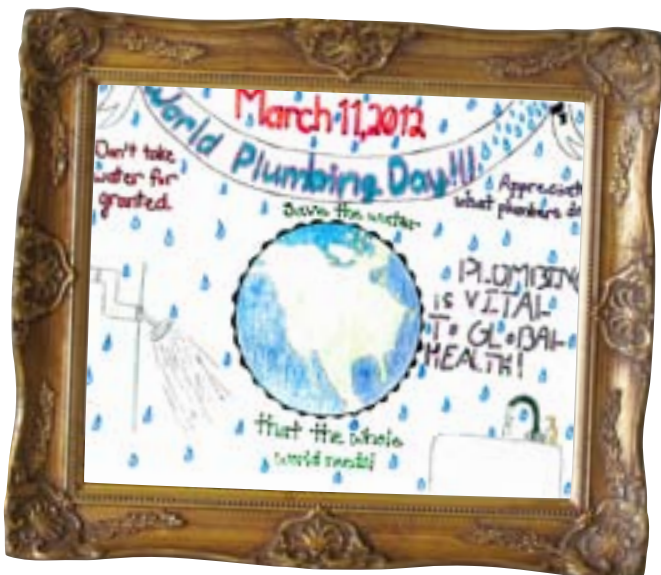

# FINALLY... SOLAR MADE EASY



- 20 Year Warranty
- All copper Heat Exchanger
- Compatible to all water quality
- Lightweight tank and collector
- Integrated TVA & Heat trap
- Slimline Design
- Quick Easy Installation
- Solar/Heat Pump combination
- Quick connect installation Kit
- Australian Made
- Profitable
- Direct product access

Designed by plumbers exclusively to you... the plumber.  
A cost effective, all in one, Hybrid Hot water system  
Delivering a "green" leading edge solution to your customer.

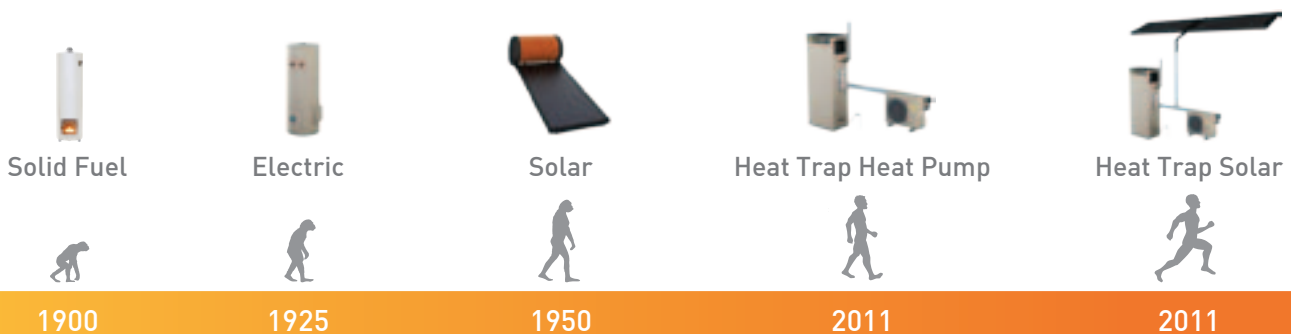

SCAN HERE



**REGISTER ON OUR WEBSITE TODAY  
TO RECEIVE YOUR INFORMATION PACK**

**HEAT TRAP**  
SOLAR PTY LTD

*"the plumbers choice"*



1300 722 715



[www.heat-trap.com.au](http://www.heat-trap.com.au)



## WA's largest infrastructure begins to take shape!

These days if you mention the name Fiona Stanley, Perth residents will know that you are referring to the \$2 billion hospital located in South Perth named after distinguished WA doctor and Australian of the Year, Professor Fiona Stanley.

It has been over 2 years since construction started at the site in January 2010 and since then the hospital has begun to take shape and impress with its modern structure and design. Brookfield Multiplex was chosen as the managing contractor for largest building infrastructure ever undertaken in WA. And Brookfield Multiplex have overseen the construction of this huge project from start to present which is continuing its growth steadily.

The hospital is set to open in 2014 and it will be the tertiary hospital in the south metropolitan area offering health care services to surrounding areas and across the State. Fiona Stanley Hospital (FSH) will be one of the best in Australia – a leader in clinical care, research and education supported by a modern design that uses the latest scientific, technological and medical developments.

The \$2 billion hospital is the largest building infrastructure project ever undertaken by the State:

- Equivalent of four city blocks
- 150,000sqm of floor space over five main buildings
- 6,300 rooms
- 783 beds, including 140 rehabilitation beds
- State-of-the-art technology on every level of the hospital
- More than five hectares of natural bush land, landscaped parks, internal gardens, courtyards and plazas
- 3,600 basement, ground level and multi-storey car parking bays



Plumbers working hard on site

### Plumbers play an important role

With over 150 plumbers onsite it is an enormous undertaking to manage a project of this size. The hydraulic consultant, SKM plays an important role in overseeing the day to day tasks that are undertaken. MPGA members Sanwell Plumbing, Axis Plumbing, Triple T Contracting & Gregory Gibson Plumbing have been instrumental in ensuring that the project is being completed on schedule and to a high standard with the plumbers starting work on site at 6.30am and downing tools at 3.30pm everyday.

of Aquatherm pipe will be used throughout the entire site. All up there will 2600 basins in the hospital and 850 pans which seems like a lot, however once opened to the public the hospital will be busy putting every single item to good use.

Plumbers currently on site at FSH are currently working with interesting and modern products. According to these plumbers some of the most interesting are the Iodine waste system for radioactive wastes and the dedicated flushing water supply which uses waste water from the main RO plant.



Some rooms are ready to be fitted with amenities

- Rainwater collection from roofs to be used for areas such as irrigation
- A centralised reverse osmosis water system which will provide water for use in key areas including dialysis, equipment sterilising units and kitchen cooking equipment. Saline waste water will be collected into storage tanks, filtered and treated before being recycled for use in the non-drinkable water supply system and flushing toilets.

2 years into construction Greg Golding, Sanwell FSH Project Manager believes that there is a growing sense of accomplishment on site between all workers. "We still have a long way to go but we can see the light at the end of the tunnel with some of the zones being completed. This job has raised the bar to a level that we have not seen in Perth before in the construction industry with the amount of checking, signing off, reports and written confirmation from suppliers about their products and installation procedures," Greg states.

Once completed FSH will be a well talked about facility across WA. The plumbers involved in the creation of this medical masterpiece will be proud to say they were involved in the construction of a hospital which will provide high quality medical assistance for south of Perth residents. No doubt the hype will continue to grow as the official opening of the hospital draws closer.



Sanwell Plumbing have over 70 plumbers onsite

As the hospital is the first of its kind to be built in WA, there are many features to the building that are new and contemporary. Training has been provided by the manufacturer's agents to ensure that all plumbers on site are up to speed on the correct methods to carry out the required work.

Due to the size of FSH, you can only imagine the amount of products and features being installed on site each day. For example a total of 48kms of DWV pipe and over 40km

Fiona Stanley will set a new benchmark for sustainability in health care design in WA and has been designed to exceed current Australian best practice in sustainable development.

Some of the features and facilities that the plumbers are working on are:

- Bathroom and other wet areas featuring low-flow fixtures to minimise water consumption



**BEN EDWARDS**  
PRINCIPAL HYDRAULICS  
ENGINEER

## Plumbing Systems in High Rise Buildings

Hydraulic services design in a high rise building directly impacts on the size and configuration of the services core. The design of these hydraulic services is problematic and must take into consideration the building height, use and location. Therefore it is important to get the principals of the design correct.

The hydraulic engineer is responsible for the design of the various plumbing systems within a high rise building, these include:

- Soil stacks and sanitary drainage
- Drinking water services
- Gas services
- Stormwater drainage systems

This article will reviews the various hydraulic systems in a high rise building and the design considerations that are taken into account when designing hydraulic services.

### Soil Stack System

A common misconception is effluent in a soil stack system will reach lightning quick speeds as it flows down soil stacks in high rise buildings. Effluent within a soil stack will reach its terminal velocity of three to five metres per second within the first five metres of its point of entry into the stack. There is no need to provide velocity breaks or offsets in soil stacks to slow down the flow of effluent.

Increased air pressure not excessive effluent pressure is a greater problem in high rise soils stacks. Negative

pressure occurs in a soil stack as the effluent enters the stack, the negative pressure increases as the effluent travels further down the stack. Below the lowest connection point into the stack the pressure increases and becomes positive pressure at the base of the stack. To prevent the positive pressure blowing trap seals and to avoid foaming at the base of the stack being a problem, stub stacks are used to receive the discharge from sanitary appliances on the lowest levels.

In high rise buildings secondary relief stacks with cross vents to the soil stack are used to control air pressure fluctuations in the stack system. The longer the relief vent the greater the volume of entrained air in the vent system. Table 7.5 in AS/NZS 3500 part 3 includes the maximum length of the vent as a factor when sizing relief vents.

Positive Air Pressure Attenuators (PAPA) can be used in place of relief and cross vents to control the air pressure in soil stack systems. The use of PAPA vents can provide savings in pipe materials, slab penetrations and riser space. However they are

mechanical devices that require access and maintenance. This adds additional cost to the plumbing installation and is another item that must be coordinated with the architect to ensure to the PAPA vales is in the correct location.

When designing hydraulic services it is essential to coordinate closely with other trades. As part of the hydraulic scope, drains are provided for the mechanical and fire services. The flow rates into these drains can be very high and may require the stack sizes to be increased.

### Drinking Water Services

Drinking water services within a high rise building must be designed to ensure the minimum water pressure of 50 kpa is maintained and the maximum water pressure of 400 kpa at the outlet is not exceeded. The height and usage of the building is a driving factor in the design of the drinking water service; this will influence the size and location of the pumps, tanks and pressure reduction valves.

## We have all the insurance solutions for plumbers and gasfitters

EBM TradesPlusCover is the competitively-priced insurance cover designed specially for you and your business.

### Comprehensive cover

Tailored insurance designed specifically to suit your business needs, with options for a package or just the cover you require.

### Broadform liability cover

Choose the level of cover you need, from \$5 million to \$20 million and upwards

### Competitive premiums

From \$751.30pa\* based on annual turnover, with included extras such as Faulty Workmanship, Contractor and Sub-Contractor cover.

### Tools & records cover

No more down time or loss of business to competitors when tools or records are lost, stolen or accidentally damaged.

### Professional service

Personal attention from a team of qualified practising insurance brokers conveniently located in cities and regional centres.

### Top insurer

Enjoy total confidence in an Australian-owned and licensed insurer who carries a Standard & Poors A+ rating.

### Full insurance services

Competitive rates for your Motor Vehicle, Worker's Compensation, Property cover and Income Protection insurance and others.

### Evidence of cover

Secure new business and put your customers' minds at rest with all the documentation you'll need to prove your liability insurance.

### Preferred MPA broker

Deal with the insurance brokers preferred by the Master Plumbers and Gasfitters Association (MPA) for over 21 years.

### Support your Association

MPA receives 25% of the commission earned by EBM on every TradesPlusCover insurance policy taken by an MPA member.



Call EBM now for an obligation-free quote.

1300 755 112

### Western Australian Offices

Perth, Bunbury, Geraldton  
Kalgoorlie

### National Offices

Sydney, Melbourne  
Brisbane, Gold Coast

[www.tradespluscover.com.au](http://www.tradespluscover.com.au)

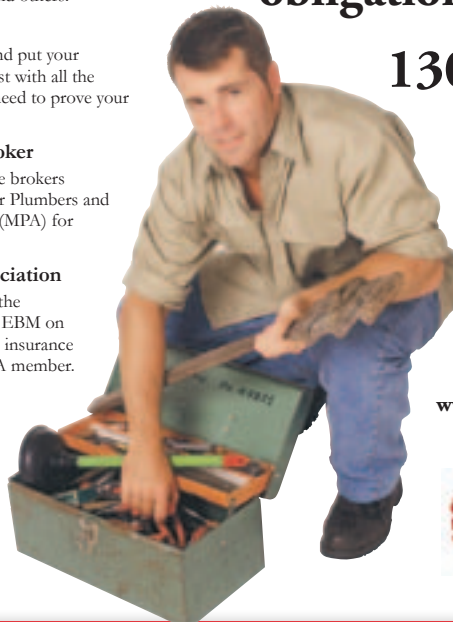

\*This is an indicative pricing for Western Australian based plumbers and gasfitters, based on 1-2 employees and liability cover of \$5 million. These terms may vary due to such things as claims and criminal conviction histories. ABN: 31 009 179 640 AFSL No: 246986

Drinking water pumps are located on the lower level of the building, usually in the basement. These pumps deliver water from the basement water tank to a drinking water tank on the roof of the building. The water service from the roof top tank to the appliances on the lower floors is called a down service. To ensure adequate water pressure on the highest floors directly below the water tank, a pump is used to pressurise the down service to the highest floors. Floors on the levels can be serviced by gravity down service from the roof top water tank.

Whilst pumping water up to the roof only to pump it down again might seem wasteful, it provides several benefits.

- It reduces pump start ups
- Ensures a constant water pressure
- Having high and low level tanks provides redundancy within the water service in the event of an interruption in the water supply service.
- Allows the water pressure in the down service to be controlled

To facilitate maintenance and to allow cleaning of water tanks, it is essential all water tanks are provided with a central division, two inlet flow control valves and outlet valves.

To reduce water pressure in the down service water tanks can be installed at intermediate levels or more economically pressure reduction valve trains can be installed on the down service. A pressure reduction valve train is a set of pressure reduction valves of variable sizes installed in parallel. The varying size valves are needed to cater for the high and low flow rates of the down service. A 50mm pressure reduction valve cannot moderate the pressure of 0.1 litre a second

flow, a 20mm valve in the valve train will be used to accommodate this low flow rate.

Hot water flow and return services cannot be installed with pressure reduction stations. Reducing the down ward pressure of the water reduces the pressure available to drive the water back to the top of the flow and return service.

### Gas Services

Natural gas services are required in high rise buildings without exception as commercial kitchens and mechanical plant in high rise buildings require gas to operate. The mechanical plant is often located in ventilated plant rooms on the roof of a high rise building.

Risers accommodating gas services must ventilate to a safe location, usually through the external façade of the building. This can result in the gas riser having to be fire rated.

The expansion of the building and the expansion of the gas service riser must be considered when designing the gas service. The expansion of the gas service will depend on the material being used, for the gas service. All piping materials expand at different rates; this will influence the location of pipe anchors, pipe guides, pipe riser clamps and spring clips.

When calculating pipe expansion and contraction it is important to consider the full range of temperatures the gas pipe will be exposed to. This includes temperatures the gas service will be exposed to during construction, when the building cooling system will not be operational. Using tables and formulas in AS 5601 the location and size of expansion loops can be calculated.

Branches from the main gas riser in a high rise building should be as close as practical

to pipe anchors as these are a fixed point. Where this is not possible connections to the main gas riser should accommodate a flexible connection, such as a braided hose to accommodate any pipe expansion and contraction.

The gas pressure at the highest point must be carefully calculated to ensure the gas service and gas appliance can accommodate the pressure and the correct gas regulators are specified. Natural gas is lighter than air, it has a specific gravity of 0.5, and hence gas pressure within the gas service will increase as the gas service rises up the building. The pressure within a gas service will increase by 12.24 mbar for every 100 metres of rise.

### Stormwater Drainage

Services riser space in high rise buildings is always at a premium; storm water drain pipes can be large and take up valuable riser space. To reduce the riser space needed siphonic stormwater drainage pipes can be installed on high rise buildings.

Like sewer effluent, storm water in a vertical drain will achieve its peak velocity with in the first three to five metres. It is important that the base of the stormwater drain is suitably support so it can withstand the weight of column of water within the pipe.

### Green Star Rating

The hydraulic services must always be closely co-ordinated with the architect, structural engineer and other building services. The repetitious nature of high rise buildings means that mistakes in design of Hydraulic services are repeated throughout the building. This can result in disruptive and expensive corrective works that can be prevented with due diligence during the design stage.

## Save time & money on installation with a

# Quickie

QUICK INSTALLATION KIT



AVG512

The Australian R&D team at AVG have developed the **Quickie Kit** for **storage hot water systems** with the plumber in mind. The conditions plumbers work in can be tough, our aim was to make the **Quickie Kit** which will **reduce the plumbers call time**, as well as giving them the **confidence** that the **job** has been **done right**.

**AS 3500 now calls on all valves and pipe work to be insulated.**

**AVG Quickie Kit** provides the **valve insulation** in the one box at **no extra cost**, giving you the confidence that the job is done right every time.

For more information on **AVG Quickie Kits** visit the AVG website on [www.avg.net.au](http://www.avg.net.au) or contact Michael on 0421 986 124.



valve insulation included

PTR insulation included

**EVERYTHING YOU NEED IN ONE BOX**

For a storage hot water system



For **storage** hot water systems

**AVG**  
Australian Valve Group  
[www.avg.net.au](http://www.avg.net.au)

AVG WA (Head Office)  
Unit 2, 9-11 Noble St, Kewdale WA 6105  
Tel: (08) 9353 2203 Fax: (08) 9353 2689  
Tel: **1800 AVG AUS (284 287)**

# Transform your business with

## MPA Skills Apprentices



Contact MPA Skills on

**9471 6600**

or visit

**[mpaskills.com.au](http://mpaskills.com.au)**



Training & Apprentice Employment  
DIVISION OF MPA GROUP



**WINNER**

SCHOOL PATHWAYS TO VET AWARD

[www.courtsinstatetrainingawards.gov.au](http://www.courtsinstatetrainingawards.gov.au)



DIVISION OF MPA GROUP



# What defines the scope of a plumber and gasfitters work?

Have you ever considered all the skills that a plumber and gasfitter should possess and what regulations support these skills and plumbing practices?

As times change, plumbers and gasfitters find themselves increasing their skills sets to adapt to an ever changing industry environment. For those that can recall, you only have to cast your mind back to the time when water and gas pipes were galvanised iron as this was the only materials available due to technology constraints. As time moves on we now find plumbing materials have progressed with major advances in technology, design and make up. Embracing these developments has been a major achievement for the industry considering the processes and compliance requirements in place.

"So what" you may say, "it's what you do these days." Unfortunately for the industry, the regulations in some regard haven't adopted this rapid progression driven by

consumers and industry demand for cost effective, efficient and environmentally friendly plumbing and gas solutions.

So where do we go from here? The MPGA is constantly working with the regulators of the plumbing and gas industry. The MPGA is striving for change where necessary and for the adoption of new technologies, materials and products to improve our working environment. By adopting new regulatory standards and codes emerging new products are able to demonstrate that they are compliant for use in the industry.

The MPGA is committed to broaden the definition and scope of plumbing work within the regulations in order to uphold the level of public health and safety and protect the environment through robust standards, regulations and quality plumbing and gasfitting practices.

On a daily basis, you rely on and support solid compliance regimes that protect the integrity of our industry. Remember, you are the ones at the industry coal face implementing current regulations and standards. We rely on your feedback to identify inadequacies so that we can communicate and address these matters with compliance regulators. We also want to see unlicensed persons processed within our compliance framework.

MPGA staff and representatives actively encourage industry consultation through participation on a number of technical groups and industry committees. These forums allow the MPGA to put forward your industry views and opinions to support the plumbing industry's future.

## Maintain good customer relations

The following tips may help your customers reduce the risk of a plumbing and gasfitting emergency and could save unnecessary expense and distress caused by an unexpected event.

The following tips may help your customers reduce the risk of a plumbing and gasfitting emergency and could save unnecessary expense and distress caused by an unexpected event. A successful plumbing and gasfitting business should maintain repeat business as this can be vital in ensuring continual work in a competitive environment.

Here are some tips to increase your repeat business:

- By identifying with your customer where the main stop valve or internal isolation valves are located on their water supply and by affixing a label to these valves, it could ultimately assist your business in the case of an emergency by stopping the water flow while you reach the site avoiding costly damage. It would be advantageous to check that the isolation valve is functioning and does in fact isolate the consumer's drinking water supply from the area of concern.
- Locating, identifying and labelling other service items including hot water, gas and hydraulic services for the customer will also prove beneficial in the case of an emergency.
- The location of any sewer drain inspection shafts and inspection openings (IO's) on the sewer drainage system is highly advantageous to the customer and can be found on an 'as constructed' drawing of the property. Knowing the location of drainage systems on a property can assist in an emergency to remove excess water or assist in draining the main water supply. Drainage inspection opening locations and inspection shafts will provide the plumber with sound knowledge when identifying blockage locations whether in the service provider's infrastructure or localised to the property.
- Ensure that exposed pipes are properly insulated in areas subject to freezing, particularly on metal roofs. Freezing is common in areas of frost where the temperature drops low enough to burst pipes on cold water lines. A guide to this can be found in the AS/NZS 3500.
- The condition of all flexible hosepipes to plumbed-in domestic appliances should be checked regularly as hoses to dishwashers and washing machines can perish. Consideration should be given to isolate these appliances in times of absence as a precaution for the customer. Flexible connections to taps and cisterns should also be checked for incorrect installation, corrosion and signs of failure.
- Continuously running overflow pipes or leaking taps is a sure sign that the plumbing system requires maintenance and this should be communicated to the customer to avoid high water consumption bills.
- Bi-annual servicing of heating appliances including water heaters and room heaters is recommended to avoid increased consumer costs when failure occurs.
- By leaving your Plumbers Licence and Gasfitters Licence details along with your contact details for use in case of an emergency is recommended to maintain your level of professionalism. The MPGA encourages members to promote being a 'Master Plumber' at all times.

# The Importance of Keeping Contracting Alive

We all know the reasons why businesses engage contractors and these reasons are probably more significant within the building and construction industry than any other. Generally speaking, they are productive and task orientated; they maintain a high standard of workmanship and they provide the flexibility the industry needs to remain viable. In fact there is a strong view that contractors are the backbone of the building industry, particularly here in Western Australia.

So it comes as a shock when we explain to business owners and contractors that this way of working is under threat. Both the ATO and Fairwork Australia have a renewed focus on the question "are your contractors really your employees"? (Sham Contracting). However, it appears that many businesses and contractors are finding it increasingly difficult to answer this question. The level of confusion is high and the risks of getting it wrong are even higher!

With close to 90% of the residential building industry comprising of small businesses and sole traders, these risks can be financially devastating. Non-compliance will certainly expose one or both parties to statutory liabilities and penalties. To avoid these risks some small to medium sized businesses are going down the 'employment' route. But let's face facts, if contractors are forced into becoming employees, the impact on their income, their productivity and

quality of work could be huge for both them and the businesses that employ them.

There is a legitimate view that the working arrangements of a particular business or individual contractor should not be decided by Government or unions and that is why we at Contracting Solutions place great importance on 'keeping contracting alive' by offering an ATO and Fair Work compliant contractor-engagement model as a viable alternative to employing. Right now, those business within the building industry - either wholly or partially - are being singled out by the ATO with its introduction of a reporting regime, which comes into effect 1 July this year. This new report requires a record of all payments made to contractors to be supplied to the ATO on an annual basis and will need to outline all payment amounts, contractor ABN numbers and GST paid to the contractor.

The question may be asked as to what else the ATO will use this information for. Another concern is, just as the GST obliged business owners to become tax collectors for the ATO, these new reporting regulations will oblige business owners to become auditors - adding to their administrative workload considerably.

What are the implications of this reporting regime on the sub-contract tradesman whose income will be reported on (many of whom have no idea this is about to happen)

and what are the implications for the businesses that engage such contractors and are compiling the report? No-one in any industry should condone sham contracting (where it exists in the true sense) nor tax evasion but the degree to which both of these issues exists is open to interpretation and/or possible exaggeration by those who would like to see an end to contracting or self-employment.

We meet regularly with either individuals or with groups of businesses and/or their contractors. By accessing the IR advice from the \*WRMC team, we are able to assist businesses to make an informed assessment of the validity of their current contractual arrangements. The aim is to show how we can help them ensure the ongoing viability of their business through the engagement of contractors. With important common law legal judgements underpinning our system, we provide a legally accepted form of business operation for those of our clients whose viability relies on the independent contractor.

MPGA has an Association Membership with Workplace Relations and Management Consultants (WRMC) who regularly provide advice and support to its members.

Contact details:

P: 1300 857 722

E: [support@contractingsolutions.com.au](mailto:support@contractingsolutions.com.au)  
[www.contractingsolutions.com.au](http://www.contractingsolutions.com.au)

**IN THE DARK**

**IN THE KNOW**

Independent Contracting has been changed. Find out how.

Becoming an employer is not your only option. We have the knowledge and solutions to put you in the clear and the best ways to handle the changing contractor regulations.

**YOUR WORK. YOUR WAY. CALL US TODAY ON 1300 857 722**

[www.contractingsolutions.com.au](http://www.contractingsolutions.com.au)

## Introducing The Quantum Ac-4 Range

Our most efficient, quietest, most economical heat pump yet!

We are proud to announce the new range of Quantum Heat Pump Hot Water Systems soon to be released that are even quieter, more efficient, and have several further improvements over our current models, whilst still utilising the same high quality components and materials.

- MORE Economical
- MORE Efficient
- LESS Noise
- MORE Hot Water Faster

TALK TO YOUR REPRESENTATIVE ABOUT THE BENEFITS OF INSTALLING A NEW QUANTUM AC4 PRODUCT TODAY!



## RIDGID 600 Series -Stainless Steel Instrument Tubing Bender

The RIDGID 600 Series Benders are specially designed for bending stainless steel, steel titanium and other hard types of tubing. A simple two-stage handle design easily switches to bend up to 180°, keeping bends in-plane and accurate.

### Unique Features and Benefits:

**In-Plane:** two-stage design allows bends from 90° to 180° without ever crossing handles. Lock and unlock with a half turn rotation of the bending handle.

**Accurate:** roll dies in bending carriage reduce tube flattening (ovality). Gain marks on form ensure properly aligned bending angles.

**Reduced force:** extra long handles for increased leverage. Vise clamp block for extra stability.

**Ergonomic:** cushioned handle grips for improved bending ease.

Call for a free demonstration, literature or the name of your nearest stockist.

### Ridge Tool (Australia) Pty Ltd

127 Metrolink Circuit, Campbellfield Victoria 3061

PHONE: (03) 9930 7000, FAX: (03) 8339 2511, EMAIL: sales.australia@ridgid.com, WEB: www.ridgid.com.au



## Need to offer an easy solar hot water solution to your customer?

You can finally offer a Heat Trap Hybrid Solar system.

This easy installed hot water solution allows you the flexibility of quick installation and turnaround times whilst maximising your profit gain.

### A solution that only plumbers can sell.....

Designed by plumbers for plumbers this innovative, sustainable, environmentally friendly, hot water system can be installed as a stand-alone Heat pump or a Hybrid Solar system.

### The Heat Trap Tank & Hybrid Solar System

Our Heat Trap tank comes with an inbuilt Energy Management System (EMS) and pressurised copper heat exchanger for optimal performance and durability.

Our Hybrid Solar system uses maxi-tube solar collectors and heat pump for reduced heating costs, and comes with features such as, an inbuilt insulated tempering valve and heat trap for easy installation.

Provided solely by Heat Trap Solar – your number one choice for true energy efficiency.

For my information visit: [www.heat-trap.com.au](http://www.heat-trap.com.au)





## MATES in Construction launches in WA

Counselling services have always been available for those in need, however it is only now that a specialised construction based counselling and support service has been developed in WA.

The fact remains that even though some may view the construction industry as one where such services are not needed, there are statistics like the ones shown below that prove otherwise.

- Young male construction workers (15-24yrs) have very high suicide rates (58.6 deaths per 100,000) which is 2.39 times greater than young Australian males.
- Male construction workers also have very high suicide rates (38.3 per 100,000) compared to Australian males (14 per 100,000).
- Construction workers are 6 times more likely to die from suicide than an industrial accident.
- Alarmingly, less than 7% of those that commit suicide seek professional help and more than half tell someone of their intention to suicide in the 12 months prior.

The above statistics are clear indicators that something more was needed to prevent suicide rates of this nature from occurring in the WA construction industry. MATES in Construction WA (MIC WA) is

an ideal support program to help reduce these statistics by raising awareness of suicide and the help available for those with mental health problems to prevent these problems from developing further.

WACIRF, the principal sponsor of MIC WA has worked hard along with the MPA Group, the Master Builders Association and the CMFEU to set up and support this program. To get the ball rolling in WA a pilot site was identified and MIC WA was officially launched at the Brookfield Multiplex Fiona Stanley Hospital building site in Murdoch. The launch coincided with World Suicide Prevention Day in September 2011 and provided a unique opportunity to test the program with over 1,500 construction workers and staff employed on the site.

Sergio Del Borrello has been appointed as the MIC WA Manager and is responsible for rolling out the program across Perth and state wide. "By raising awareness and connecting workers to help, we will build the industry's strength and its capacity and resilience to deal with issues that can lead to suicide" Sergio explains.

MIC WA run an industry specific program for construction workers. The MIC WA program aims to influence the on-site culture by raising suicide awareness and educating workers on how to identify signs that a co-worker is in need of help so that they can be linked to a network of health care professionals.

MIC achieves three things when applied on-site:

- Raised awareness of suicide as a prevention problems
- Making getting help easy
- Ensuring the help is appropriate

For more information about how you can get involved in this program or to learn more about MIC please contact MIC WA on the details provided.

**If you or a mate are doing it tough in WA and need help now, call MIC 24/7 on 1300 MIC 111 (1300 642 111). If you would like to know more about MIC WA, contact Sergio Del Borrello directly on 9463 6664.**



## Rheem invests in the future!

Rheem celebrates 75 years with 75 Rheem Plumber Apprentice Grants now available

As part of its 75 year celebration, Rheem Australia has launched the Rheem Apprentice Plumber Grants, a scheme designed to thank the Australian plumbing industry for its ongoing support and to invest in its skills future. Seventy five \$1,000 grants are available this year for apprentice plumbers most in need of financial assistance.

"It goes without saying that young people entering the plumbing profession at apprentice level really are the future of the industry," says Matt Sexton, CEO Rheem Australia. "But we know it can be tough financially, especially for apprentices just starting out and many do not go on to complete their

training. We therefore encourage all current plumbing apprentices across Australia to apply for these grants and hope they will make a real difference for those who are selected," explains Matt.

There are no restrictions placed on the grant; successful recipients can decide how and when they use it – e.g. on tools, education, bills, or fuel to get to or from work. Applications for the Rheem Apprentice Plumber Grants open on 15 May and close on 15 August 2012, with the recipients announced on 28 September 2012. Apprentices can nominate themselves or their employer can do so. As part of the process, TAFE and Registered Training Organisation Trainers will be contacted as a reference check. In order to ensure

the grants are awarded fairly, a panel of independent industry experts facilitated by Rheem's National Product Training Manager, Tony Djodan will judge all applications.

"These grants are a token of Rheem's appreciation for all the young people entering the industry. Each application will be assessed on its own merit and we look forward to announcing the recipients in late September," says Tony.

**For more information on the Rheem Apprentice Plumber Grants or to download an application form, head to the Rheem website [www.rheem.com.au/Apprentice](http://www.rheem.com.au/Apprentice)**

# What the?



Deck of card urinals! What suit would you choose?



Roll up roll up!  
For the softest toilet in town!



The plumbing industry has been relying on

# cbus

for the last 25 years.

At Cbus, we look after our members by:

- investing back into the industry
- having low fees and paying no commissions to financial advisers
- being run only to benefit members.

If you're in the plumbing industry – Cbus is your industry super fund.

Call Cbus on 1300 361 784 or visit [www.cbussuper.com.au](http://www.cbussuper.com.au)



Cbus' Trustee: United Super Pty Ltd ABN 46 006 261 623 AFSL 233792 Cbus ABN 75 493 363 262. Read the Cbus Product Disclosure Statement to decide whether Cbus is right for you. Contact 1300 361 784 or visit [www.cbussuper.com.au](http://www.cbussuper.com.au) for a copy.

# Tyco Flow Control

delivering all the backflow answers



**We can provide you with a practical & affordable backflow solution for every application**

- Reduced pressure zone
- Double check
- Dual check
- Single check
- Detector assemblies
- Watermark butterfly valves
- Watermark resilient seated gate valves
- Complete assemblies with isolation valves & strainers
- AS/NZS 2845.1
- Australian Made

**tyco** / *Flow Control*

**Phone: 1300 790 583**

w w w . t y c o f l o w c o n t r o l . c o m

# A reminder to identify, isolate and secure sources of energy

It is easy to overlook an energy source, but the potential consequences of doing so can be tragic. Members are reminded to utilise appropriate identification, lockout and tagout procedures when energy sources within your work areas are located. Failure to follow these procedures may result in loss of life, wages, employment, your business and/or prosecution from regulators.

Energy sources that can cause personal injury include mechanical (vehicles), hydraulic (fluids under pressure), pneumatic (compressors), chemical and thermal (artificial heat and the sun). The failure to properly lockout and tag equipment may result in debilitating injuries. Before you commence work, review the scope of work with your client and/or supervisor. Check the system you will be working on. Look for all potential energy sources you may come in contact with in the course of the task you are preparing to do.

**If you don't know what it is, leave it alone until you can confirm whether it may be a hazard!**

When you identify an energy source, determine the best method of isolating it. You can often isolate an energy source without having

to lock it out or you may need to lockout other sources to isolate that one. Remember to isolate and lock out energy sources that may feed another that you may be working on or in the vicinity of. If on a construction site where you are a sub-contractor, review the lockout/tagout procedures required by person in control of the workplace. These may differ from your own procedures or require additional steps such as consultation/interaction with other trades on site.

Determine how control devices will respond when power is removed. For example, electrically-operated valves may fail open, fail closed or maintain their position. Their failure mode is independent of their actuation because valves use two different means. For example, a valve that requires energy to open may also fail open upon loss of power. Be aware of how this affects the process so you don't create a hazard for others or the environment.

Likewise, some mechanical plant may continue to move (e.g. conveyors) after being de-energised and come to rest in a position not able to be determined by the removal of power. Be aware of residual stored energy in a system

even after it has been isolated; vent gas pipes, compressor cylinders or hydraulic hoses after they have been effectively isolated as residual pressure is likely to remain. Before you commence work on an isolated piece of equipment, verify that energy sources are effectively isolated. Use a meter to check for voltage, use pressure gauges and thermometers to verify no hydraulic or thermal energy and use your eyes to inspect everything. If using them, check your locks and tags before returning to work if you have left the work area, even for a few minutes.

Once your tasks have been completed and you are due to restore the energy source, inspect your work thoroughly before restoring the energy source. Have a qualified employee review the work before personally removing your locks and re-energising energy sources.

You may need to follow detailed start-up procedures when re-energising a system after lockout/tagout. If you do not know how to start it up, don't try.

For more information on this topic or any other OHS inquiry, please do not hesitate to contact the MPA to arrange advice and assistance from Safety Solutions WA.

Construction  
Automotive  
Industry



## RAUPIANO PLUS THE VERSATILE ACOUSTIC DRAINAGE SYSTEM

### PEACEFUL, COMFORTABLE LIVING THE BEST IN SOUND INSULATION TECHNOLOGY

Proven performance through extensive acoustics testing under Australian construction conditions and endorsed by local acoustics consultants.

Eliminate acoustic lagging

### EXCELLENT PROPERTIES FOR A BROADER APPLICATION RANGE

Highly resistant to a wide range of chemicals and temperatures. It can withstand pH ranges from 2 to 12 and temperatures up to 95°C.

Trade waste approved

### GREEN, NON-TOXIC AND ODOURLESS

RAUPIANO PLUS leaves a small carbon footprint as it takes less energy to fabricate from raw material to final product. The material contains no toxic chemicals, such as Halogens, and is 100% recyclable.

Increase green star rating

For more information, call (08) 9456 0700 or email [perth.admin@rehau.com](mailto:perth.admin@rehau.com)  
[www.rehau.com](http://www.rehau.com)

# RIDGID®

## K-45AF Drain Cleaning Machine **NEW**

The K-45 family of drain guns are the professional choice for cleaning small secondary drain lines from 3/4" (19mm) to 2 1/2" (63mm).

- **Variable Speed Operation**  
– Fully variable from 0-600 RPM to give you complete control in every situation.

- **Leak Proof**  
– Inner drum prevents leakage to keep job site clean.

**K-45AF-Autofeed** – The advanced 2-way Autofeed lets you clean drains better and faster than ever before – keeps hands off cable and gives you total control to completely work through blockages and retrieve obstructions.



## KJ-3100 Water Jetter **NEW**

Jets 2" to 10" (50mm-200mm) Drain Lines  
The RIDGID KJ3100 portable Water Jetter delivers 3000psi actual working pressure to handle large commercial and industrial applications.

- **Lightweight Hose** with nylon braid provides significant weight reduction and flexibility
- **Removable** hose reel
- **Manoeuvrable** – the clever design makes this machine one of the most manoeuvrable on the market
- **Quick Startup** – 6HP Recoil start petrol engine is reliable and robust.



Who else but RIDGID gives you the confidence, service and product reliability. **No one but RIDGID.**

**We Build Reputations™**



**Call for a free demonstration, literature or the name of your nearest stockist**

Ridge Tool (Australia) Pty Ltd ABN 96 008 446 482  
127 Metrolink Circuit Campbellfield Victoria 3061

phone **1800 743 443** fax **03 8339 2511**  
email **sales.australia@ridgid.com**  
web **www.ridgid.com.au**



RT681VA

## Keeping Disease-Free At Work: Understanding Hepatitis



**DR. JOE KOSTERICH**  
WWW.DRJOE.NET.AU

One major achievement in the twentieth century was the decline in infectious diseases due to better sanitation and the advent of immunisation. Some diseases that were commonplace as recent as 50 years ago are rare in Australia today.

However, it is fairly easy to be lulled into a false sense of security too. Hepatitis, in particular has not been eradicated and it is important to be protected against it - especially if working in industries where exposure is more likely.

Hepatitis is an infection of the liver. Symptoms typically include fever, nausea and vomiting abdominal cramps, loss of energy and appetite and yellow jaundice in some. There are a number of different types with Hepatitis A, B and C being the three most common.

Hepatitis C is predominantly transferred via shared needles and there is no vaccine against it, however it is not likely that you would catch whilst at work.

Hepatitis B can be transferred by blood contact (hence the blood rule in sports) and can be sexually transmitted. Compared to Hepatitis C it is more contagious via blood or other body fluids and can cause illness ranging from mild to severe and can be fatal in rare cases.

Hepatitis A is the mildest form of the three and is typically spread through contaminated food and water.

There are vaccines for both Hepatitis A and B and anyone working in plumbing or construction is advised to be vaccinated against both. This can be done separately or together. The most common course of vaccinations is a series of three injections over a six month period. A 'rapid' course is also available and administered over 21 days or 2 Hepatitis A injections can be administered one year apart. It is important to discuss the best option for you with your doctor.

In the late 1990's the Hepatitis B vaccine was included on the childhood roster of vaccines so in the not too distant future, people entering the construction industry will already be immune to this type of hepatitis.

The question everyone asks is how long does immunity last? In most people immunisation against Hepatitis A and B will give life long cover if the course has been completed. There are exceptions to the rule and whilst there is no exact expiry date, your level of immunity can be tested by a standard blood test every 10 to 15 years.

The other disease to be protected against is of course tetanus. This is one of the routine childhood immunisations. Until about ten years ago it was recommended for people to have a routine booster every ten years. Now, after the booster at age 13 the next routine shot is recommended at around age 50. Health care practitioners will administer a booster if a cut or break of the skin surface appears to be tetanus prone.

Like many things in medicine, immunisation can seem confusing but it need not be. If you are in doubt about your immunity, have a chat with your doctor.



## MPA Skills' gas workshop makeover

Due to a new plumbing training package and on going changes to the plumbing industry, MPA Skills recently refurbished its gas training and assessment centre at Maylands. The gas facility at MPA Skills has been updated to house a much improved gas training centre.



**WAYNE MORLING**  
MPA SKILLS  
GENERAL MANAGER

The renovations to the facility include and incorporate 19 new gas training and assessment areas for students to install and commission meters, cylinders, pipework and various gas appliances ranging from traditional appliances to modern condensing Hot Water Units. This area is also home to a fully operational commercial kitchen and LPG installations including a caravan, boat and a 2 stage LPG system as well as standard domestic natural gas and LPG bottle installs.

With the physical infrastructure altered, the assessment process has also been stepped up to another level. To ensure all students are assessed individually there is a separate assessment area, which is situated close to the various mock gas installations that gasfitters may encounter on the job.

As well as serving as the gas training institute, the centre also contains up-to-date gas servicing equipment which provides the latest information and procedures to trainees enabling gasfitters to service and repair new and old Type A gas appliances.

MPA Skills offers various courses available for existing gasfitters so please phone the Advanced Training Department on 9471 6600 for more information.



Trainers Damian Tabram & Mike Broomhead in the renovated training room

## 2012 Annual Apprentice Awards

The 2nd Annual Apprentice (AA) Awards were held in April to highlight the exceptional level of training on offer by MPA Skills.

32 plumbing apprentices were vying to be given recognition as a quality apprentice that is undertaking their training at MPA Skills. The competition was held over 2 days and open to 1st, 2nd, 3rd & 4th year apprentices. The MPA Skills AA Awards are seen as a pre-cursor to the Apprentice of the Year Competition that is conducted by the MPGA.

The practical component of the competition saw the apprentices undertaking a challenging project that tested their knowledge and skills. All of the apprentices should be congratulated on taking the opportunity to compete in this environment.

MPA Skills General Manager Wayne Morling said "The object of the AA Awards is to give the opportunity for the apprentices to be recognised by their industry and strive towards been the best apprentice they can possibly be, it is important that they continue to look for opportunities that will see them grow in their knowledge, skills and professionalism."

MPA Skills Training & Apprentice Employment would like to congratulate the following winners:

**Plumbing**

- 1<sup>st</sup> Year Luke Brown
- 2<sup>nd</sup> Year Harrison Byrne
- 3<sup>rd</sup> Year Tim Newton
- 4<sup>th</sup> Year Giulio Balla

# Plumbcrete

MANUFACTURERS OF CUSTOM PRECAST & CONCRETE PLUMBING PRODUCTS

Plumbcrete products can be purchased at leading plumbing supply stores throughout Western Australia. Plumbcrete concrete products provide the benefits of strength and durability.

Plumbcrete is a Western Australian owned family business that has been supplying concrete plumbing products since 1985.

Email [sales@plumbcrete.com.au](mailto:sales@plumbcrete.com.au)

 Valve Boxes	 Inspection Shaft Mounds	 Downpipe Traps
 Spoon Drain Channels	 Flatback Traps	 Sump Boxes

www.plumbcrete.com.au



**BRYCE STEELE**  
Business Development  
Manager

## MPGA Members receive more!

At the MPGA we are constantly listening to what our members need to help them run a successful plumbing business, here are just a few of the ways we can help you:

### Training is a common theme throughout regional Western Australia

Over the past few months the MPGA has travelled throughout regional WA and has received a common thread of feedback being the high demand for training in regional areas for a variety of courses including the Plumbing Contractors Licence, Backflow Prevention and the Envirowest Courses. Plumbers in regional areas don't have the time to be able to leave their home town and head to Perth to undertake training so, in conjunction with MPA Skills we are set to roll out our Regional Training Calendar which will incorporate both an e-learning component along with an in person training component where an MPA Skills Trainer will be travelling to the major regional centre to deliver the training.

### MPGA 2012 Pricing & Estimating Guide

The 2012 MPGA Pricing & Estimating Guide is just one of the many benefits you receive by being a member of the MPGA. The latest edition includes everything you need to know about pricing and estimating plumbing work in WA. Thanks go to Executive Committee Member, Peter

Thompson and MPGA Technical Services Officer, Andrew Okines for their assistance in updating this well respected industry source. Additional copies are available from MPGA Membership Services.

### MPGA Quotation & Contracts Pad

Additional copies of the Quotation & Contracts Pad are now available from MPGA Membership Services. Using this quote template ensures compliance with the Home Building Contracts Act 1991.

### Small Business Seminars

The MPGA recently conducted a 3 hour seminar on understanding and making a profit hosted by Action Coach, Leanne Shaw. Further seminars conducted by Leanne are planned for 2012 including:

**How to handle your apprentice**  
4th July

**How to market your business**  
12th September

**How to get the rights sales pitch**  
13th November

### Are you owed money?

Did you know that MPGA members are entitled to a free Initial Letter of Demand?

With the support of MPGA service provider, Doyles Construction Lawyers MPGA members are entitled to a free Initial Letter of Demand to assist with debt recovery. To take advantage of this membership benefit, log onto the members area of the MPGA website and download the required form, once completed forward to Doyles Construction Lawyers who will assist you from there.

### Is your Plumber a Master Plumber?

April and May saw the commencement of our 'Is your Plumber a Master Plumber?' consumer awareness campaign in all 17 publications of the Community Newspapers delivered to over 720,000 houses throughout the Perth metropolitan area. Over the coming months you will continue to see this campaign promoted throughout WA in both radio and print. If you're a member and you advertise why not utilise the MPGA logo?

To find out more about these benefits and how else we can help you contact MPGA Membership Services on 9471 6600 or visit the MPGA website [www.masterplumbers.asn.au](http://www.masterplumbers.asn.au)



## PLUMBERS PRICING & ESTIMATING GUIDE

**OUT NOW**  
for MPGA members

Contact the Master Plumbers & Gasfitters Association of Western Australia for your copy

PHONE (08) 9471 6661

FAX (08) 9471 6663

ADDRESS 353 Shepperton Road,  
East Victoria Park, WA 6101

EMAIL [mail@mpawa.asn.au](mailto:mail@mpawa.asn.au)

WEB [masterplumbers.asn.au](http://masterplumbers.asn.au)

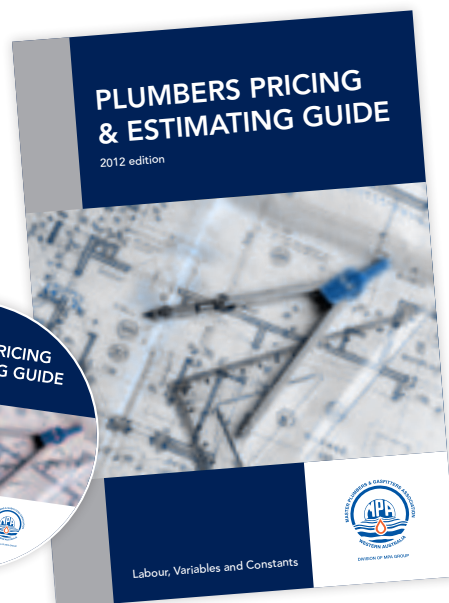
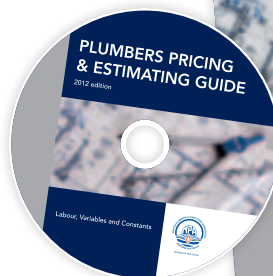

# Buy 4 & Score

Simply purchase 4 Dux water heaters from one of the categories below between 14th May 2012 to 31st August 2012 and win!

## Buy any 4



Product Category: Continuous Flow

=



Purchase 4 Endurance continuous flow in any combination to receive a **\$100 Coles Myer gift card**

## Buy any 4



Product Category: Gas Storage

OR



Product Category: Large Electric

=



Bose SoundDock II  
RRP \$349

OR



V8 Bar Fridge  
RRP \$349

Purchase any 4 Dux Proflo 80L, 125L, 160L, 250L, 315L or 400L in any combination OR purchase any 4 Dux Prodigy 3, Prodigy 4 or Prodigy 5 and receive either a **Bose SoundDock series II digital music system RRP \$349** OR a **V8 70 litre Bar Fridge RRP \$349**

## Buy any 4



Product Category: Environmental

=



iPad  
RRP \$789

Purchase any 4 Dux Sunpro Solar or Airoheats in any combination to receive an **Apple iPad RRP \$789**

Simply visit [www.dux.com.au/promotions](http://www.dux.com.au/promotions) and download your claim form!!

Maximum Claims: 3 of each prize per plumbing company. Claims using 4 units from different 'Product Categories' are not eligible.

'Buy 4 & Score' Promotion commences on the 14th May 2012 and concludes on the 31st August 2012. Maximum claims: 3 of each prize per plumbing company. This promotion is only available to 'Eligible Purchasers', which are defined as licensed plumbers in Australia. Every purchase of four Dux Endurance continuous flow (any combination of Product Category: Continuous Flow), thereby creating an 'Eligible Purchase', will be awarded in accordance with these conditions, one Coles Myer gift card valued at \$100. Every purchase of four Dux Proflo Electric Storage 80L-400L (any combination of Product Category: Large Electric), thereby creating an 'Eligible Purchase', will be awarded in accordance with these conditions, either one Bose SoundDock series II digital music system RRP \$349 OR one 70 litre Bar Fridge RRP \$349. Every purchase of four Prodigy 3, Prodigy 4 or Prodigy 5 (any combination of Product Category: Gas Storage), thereby creating an 'Eligible Purchase', will be awarded in accordance with these conditions, one Bose SoundDock series II digital music system RRP \$349 OR one 70 litre V8 Bar Fridge RRP \$349. Every purchase of four Dux Sunpro electric boosted solar, Sunpro gas boosted solar or Airoheat heat pump (any combination of Product Category: Environmental), thereby creating an 'Eligible Purchase', will be awarded in accordance with these conditions, one new Apple iPad 32GB with wifi +4G valued at \$789. Claims using 4 units from different 'Product Categories' are not eligible. Valid tax invoices AND serial numbers must be submitted to be eligible. Radiant branded product is specifically excluded from this promotion. Allow 10 weeks for delivery of prizes. Final date for claims to be received by Dux Marketing by 15th September 2012. None of prizes in the 'Buy 4 & Score' are transferable, redeemable for cash or can be used in conjunction with any other promotional offer or tank rebate. All prizes subject to availability. Dux reserves the right to switch any prize not available for an alternate prize of equal or greater value. The 'Promoter' is Dux Manufacturing Limited (ABN 19 077 879 844) "Dux", PO Box 6089, Silverwater NSW 2128. DUX, ENDURANCE, PROFLO, PRODIGY, SUNPRO and AIROHEAT are registered trade marks of Dux Manufacturing Limited. All other trade marks appearing in this promotion are the property of their respective trade mark owners.



# GET 20% MORE BILLABLE TIME

Driving to and from the office to drop off paperwork results in non-billable downtime for your technicians.

A technician's time is money and their hours need to be billable. Cut down their admin travel time with simPRO Field Mobility and increase billable hours by 20%\*.

How Much is Driving to and From the Office Costing You?

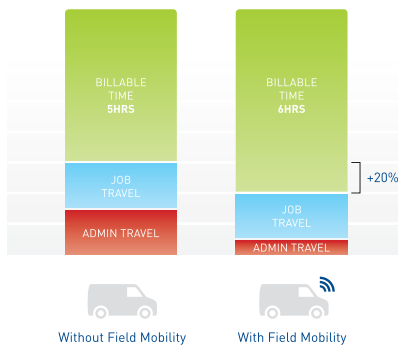

Available on Your Preferred Mobile Platform



Stay connected and keep your entire system up-to-date with real-time overviews of labour and material costs updating directly to your simPRO Job Management System.



Macintosh • iOS • Android • Windows • Windows Mobile • Anoto



Fully Integrated with  
simPRO Enterprise  
Job Management Software

Estimating  
Purchasing  
Scheduling  
Project Management  
Stock Control

Asset Maintenance  
Invoicing  
Field Mobility  
Customer Login  
Vehicle Tracking

\* Indicative figure only, results may vary from business to business.

Keep your business moving with simPRO Mobile.  
Contact us today on 1300 139 467 to get connected.



simpro.com.au